



MASON INDUSTRIES, Inc.

MERCER RUBBER Co.

350 Rabro Drive, Hauppauge, NY 11788
 Mason- 631/348-0282 • Info@Mason-Ind.com
 Mercer- 631/582-1524 • Info@Mercer-Rubber.com
 FAX 631/348-0279



JOB NAME _____
 CUSTOMER _____
 CUSTOMER P.O. _____
 MASON M. _____
 DWG No. _____

ECMN

2" (50mm) Movement
 EXPANSION
 COMPENSATORS
 with CARBON STEEL
 THREADED NIPPLES

Bellows are externally pressurized. 3.5 Minimum Safety Factor for both Bellows and Housing.

PRESSURE REDUCTION TABLE

Temperature (°F)	Temperature (°C)	Rated Pressure (psi)(kg/cm ²)	
200	93	188	13.0
250	121	184	12.7
300	149	176	12.1
400	204	166	11.4
500	260	156	10.8
600	316	148	10.2
700	371	140	9.7
800	427	Not Recommended	

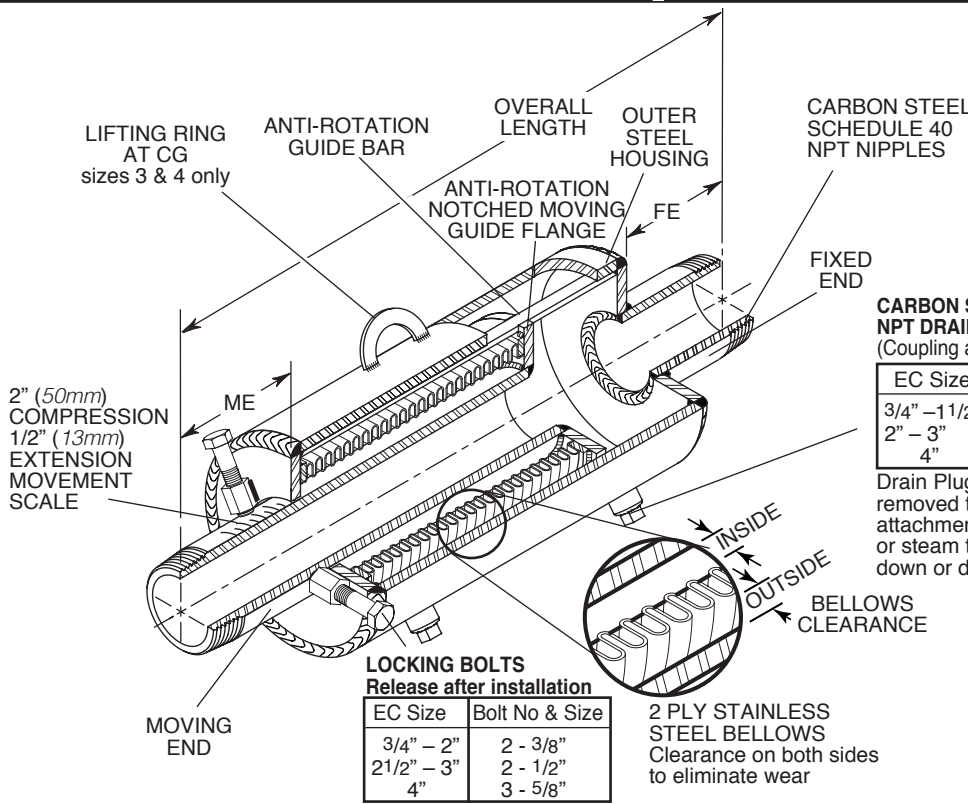

CARBON STEEL NPT DRAIN PORT (Coupling and Plug)

EC Size	Plug Size
3/4" - 1 1/2"	1/4"
2" - 3"	3/8"
4"	1/2"

Drain Plugs are often removed to allow attachment of drain hose or steam trap for blow down or drainage.

LOCKING BOLTS Release after installation

EC Size	Bolt No & Size
3/4" - 2"	2 - 3/8"
2 1/2" - 3"	2 - 1/2"
4"	3 - 5/8"

2 PLY STAINLESS STEEL BELLOWS Clearance on both sides to eliminate wear

Full Vacuum Rating- 30" (762mm) Hg

ECMN DIMENSIONS AND PRESSURE RATINGS (American & Metric Units) 2" (50mm) COMPRESSION, 1/2" (13mm) EXTENSION

Type & Size	Pipe Size (in) (mm)	Overall Length (in) (mm)	ME		FE		Outer Housing O.D. (in) (mm)	Nominal Bellows Clearance		Spring Rate (lbs/in) (kg/cm)	Thrust* @ 200 psi (lbs) (kg)	Thrust* @ 13.8 bar (psi) (kg)	Rated Pressure @ 70°F @ 21°C (psi) (kg/cm ²)	Ship Wt. (lbs) (kg)
			Neutral Length (in) (mm)	Fixed End Length (in) (mm)	Inside (in) (mm)	Outside (in) (mm)								
ECMN-3/4	3/4 20	12 1/2 318	3 3/4 95	15/8 41	27/8 73	0.10 3	0.43 11	89 16	350 159	200 14	7 3			
ECMN-1	1 25	12 1/2 318	3 3/4 95	15/8 41	3 1/2 89	0.13 3	0.55 14	95 17	500 227	200 14	10 4			
ECMN-1 1/4	1 1/4 32	13 330	4 102	17/8 48	4 102	0.15 4	0.47 12	103 18	800 363	200 14	11 5			
ECMN-1 1/2	1 1/2 40	13 330	4 102	17/8 48	4 1/2 114	0.17 4	0.46 12	106 19	1100 499	200 14	13 6			
ECMN-2	2 50	13 1/2 343	4 1/8 105	2 1/8 54	5 1/4 133	0.17 4	0.52 13	110 20	1600 726	200 14	16 7			
ECMN-2 1/2	2 1/2 65	14 1/4 362	4 3/8 111	2 1/4 57	6 1/4 159	0.24 6	0.53 14	126 23	2400 1089	200 14	23 10			
ECMN-3	3 80	14 3/4 375	4 1/2 114	2 1/2 64	6 5/8 168	0.32 8	0.37 9	140 25	3500 1588	200 14	32 15			
ECMN-4	4 100	14 3/4 375	4 1/2 114	2 1/2 64	8 5/8 219	0.33 8	0.81 21	150 27	5200 2359	200 14	50 23			

*Lower Thrust Forces in proportion at lower pressures, i.e. 100 psi Force = 100/200 x published Thrust. Forces on Pipe Anchors must include Thrust Force and Spring Force. Spring Force is determined by multiplying the joint Spring Rate by its Thermal Movement. (in/mm)

EC's installed in piping systems must be anchored on both sides of the joint. EC's installed in unanchored piping must have control rods.

When using ECMN products in copper or brass water or steam systems, dielectric unions must be used on each end to prevent leakage from galvanic action.

GUIDE SPACING - Referencing Pipe Diameter "D"

Guides and Anchor for ECMN located near Anchor

Guides and Anchors for ECMN located between Anchors

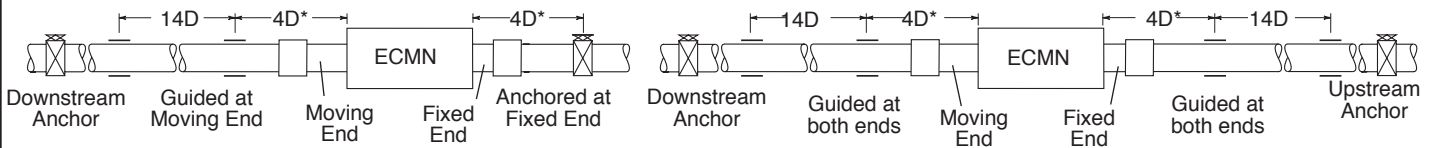

*Plus an additional 3" (76mm) for Sizes 3/4" to 2 1/2"

QTY	SIZE	TAG

QTY	SIZE	TAG